

MANUALE D'USO

AM02/60*
AM02/60N**
GANCIO SINGOLO IN ALLUMINIO CON ½ SPINOTTO
COMPATIBILE TUBO DIAMETRO 60 mm
PORTATA 500 KG

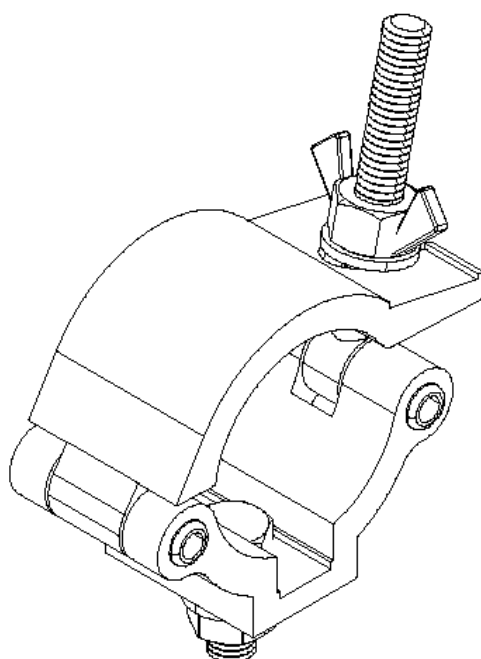

Finitura verniciato argento() o verniciato nero(**)*

CE

ASSEMBLAGGIO ACCESSORI

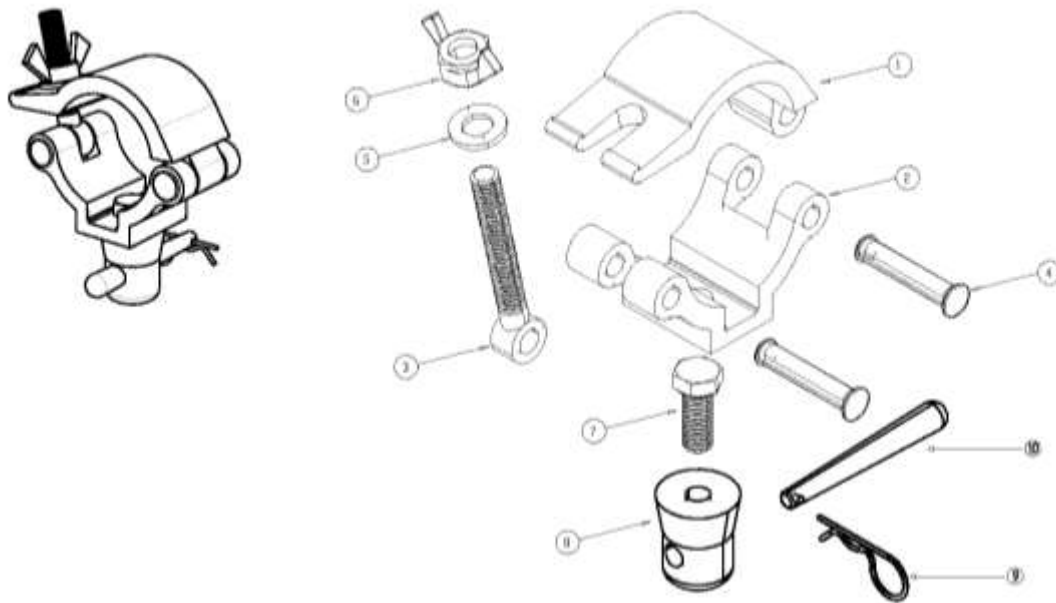

Numero	Codice	Descrizione	Quantità
1	AS01/60-Concavo*	Parte concava verniciata silver	1
	AS01-60-Concavo**	Parte concava verniciata nera	
2	AS01/60-Convesso*	Parte convessa verniciata silver	1
	AS01/60-Convesso**	Parte convessa verniciata nera	
3	DC/F11-95	Dicchiello filettato M12, lunghezza totale 95mm	1
4	R1054	Ribattino semiforato Ø10x54mm, zincato testa piatta	2
5	RD12	Rondella Øint 12mm	1
6	DAL12	Disco ad aletta zincato Ø12	1
7	B1220EZ	Bullone dim. 12x20 mm testa esagonale zincato	1
8	99	½ spinotto diam. 34.7 mm Foro M12	1
9	F502	Fermo di sicurezza dim. 30x2 mm	1
10	S	Spina conica L. 90 mm in acciaio zincato	1

AM02/60* - GANCIO SINGOLO CON ½ SPINOTTO "SILVER FINISH"

AM02/60N** - GANCIO SINGOLO CON ½ SPINOTTO "VERNICIATO NERO"



PRESCRIZIONI DI UTILIZZO E ISTRUZIONI DI MONTAGGIO

Prescrizioni per l'uso:

1. Non superare il carico di lavoro indicato nella scheda tecnica;
2. Utilizzare il gancio esclusivamente entro i parametri del tubo di progetto;
3. Ispezionare visivamente il gancio prima dell'uso. In caso di danneggiamento mettere fuori servizio;
4. Combinati con altri accessori, prestare attenzione a non superare la portata minima di qualsiasi componente;
5. Il gancio va utilizzato solo in un orientamento verticale (Fig.1). In caso contrario ridurre il carico;



Figura 1 Configurazione di lavoro.

6. Per un corretto utilizzo applicare al dispositivo di serraggio su tubo un momento torcente pari a 32 Nm.

Istruzioni di montaggio:

[Per le istruzioni di montaggio e per ulteriori chiarimenti si rimanda al sito \[www.efestoproduction.com\]\(http://www.efestoproduction.com\) alla sezione **Ganci**.](http://www.efestoproduction.com)

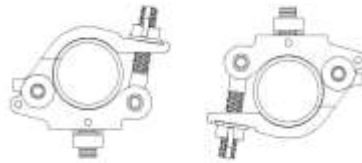

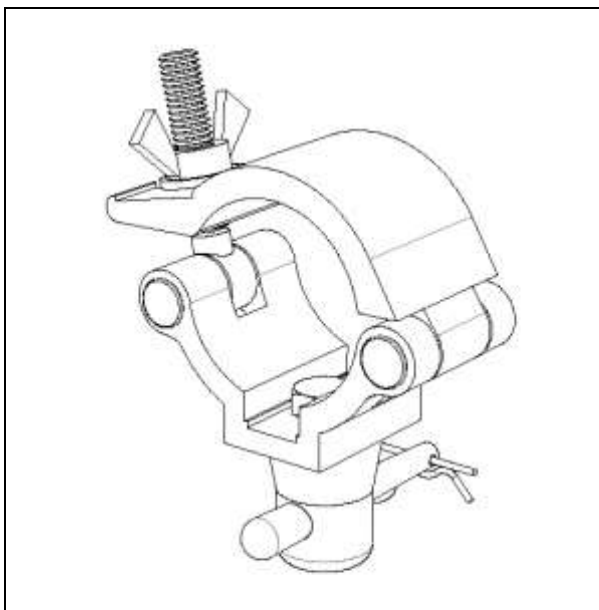
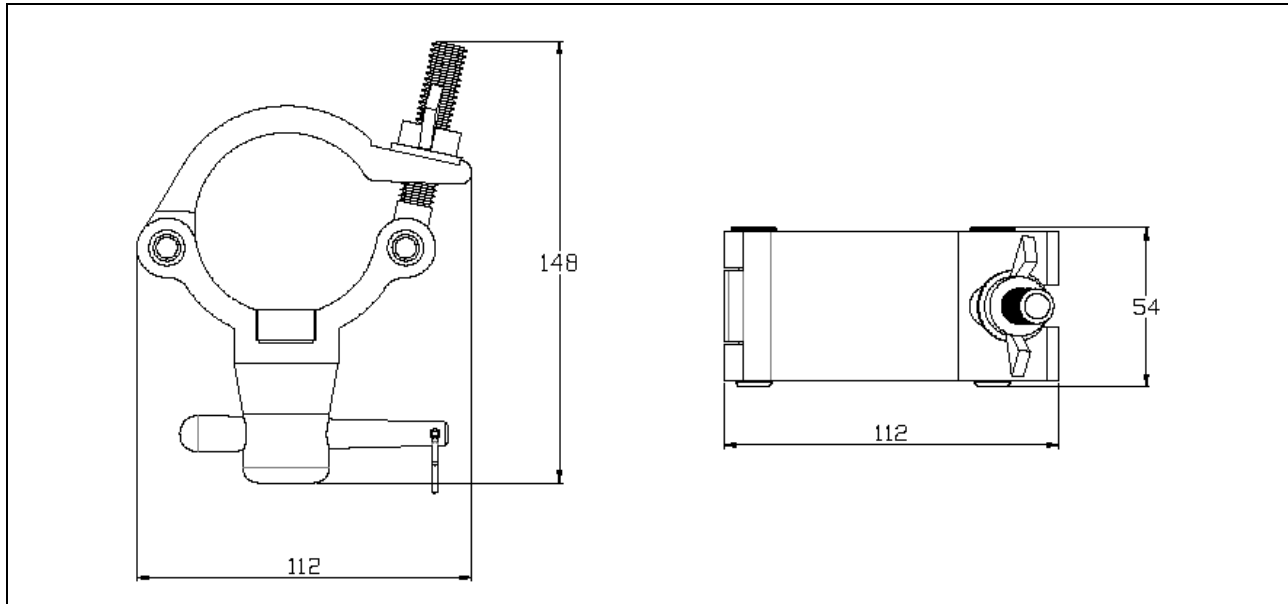
SCHEDA TECNICA

Specifica Tecnica
Dimensioni / Dimensions

148x112x54 mm

Materiale / Material

Lega EN AW-6082 T6

Finitura superficiale / Surface finish

*Verniciato argento / Painted silver

*Verniciato nero / Painted black

Peso / Weight

0.670 kg

Volume trasporto / Transport volume

 0.00090 m³
Portata / Max. load

500 kg

Note / Notes

diametro tubo (tube diameter) – 60 mm



SERIE GANCI

Si riportano, di seguito, la serie di ganci prodotti, disponibili in alluminio lucido o verniciato nero:

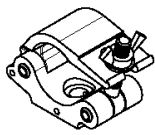

AS01



AS01S

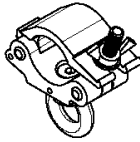

AG04



AG04S

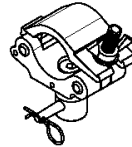

AM02

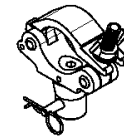

AM02S



AS01/60



AS01/60G



AS01/60M02

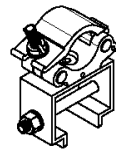

AS01/GCS



AS01/ST5050

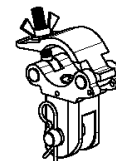

AS01/SU5050

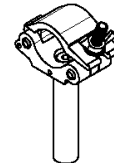

AS28

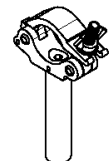

AS28S

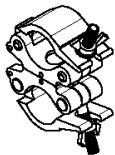

AD03



AD03S

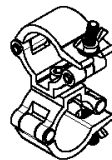

AD03/60

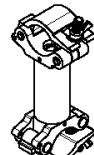

B/AS01



GC/01



GC/01A



GC/01AG



GC/01AM02

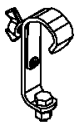

GC/01S



GC/01V

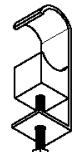

GC/02

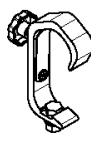

GC/02A

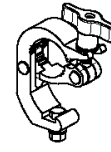

GC/03A



GC/03AG



GC/03AM02



GC/04A

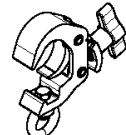

GC/04AG

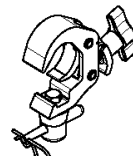

GC/04AM02



GC/05A

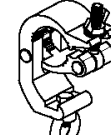

GC/05AG



GC/05AM02

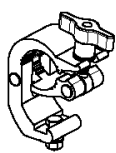

GC/06A

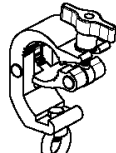

GC/06AG

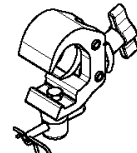

GC/06AM02

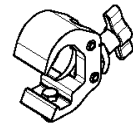

GC/07A

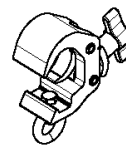

GC/07AG

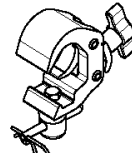

GC/07AM02

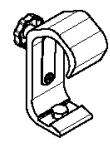

GC/08A

