

ST/03G
SUPPORTO TRALICCIO CON GOLFARE AD ESTENSIONE REGOLABILE Min 30 – Max 40cm
COMPATIBILE TUBO DIAMETRO DA 48 A 51 mm
PORTATA 340 KG

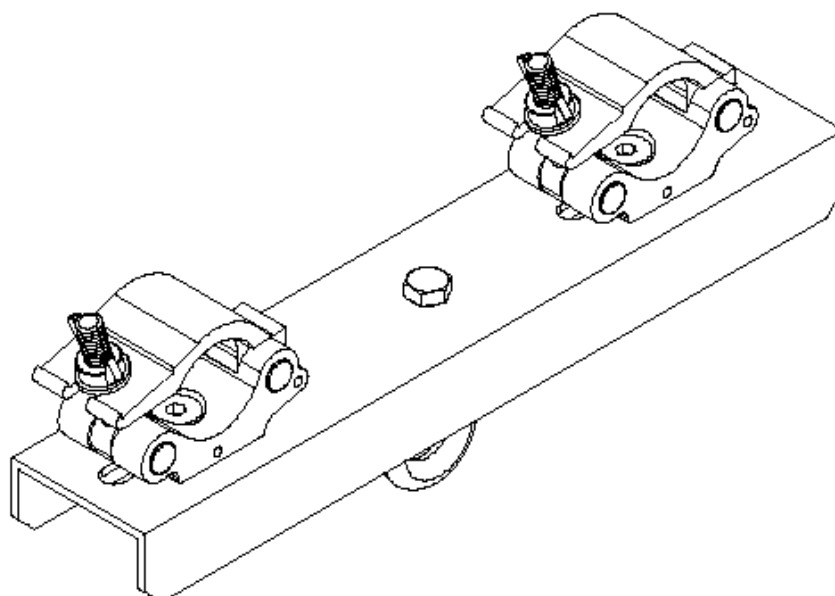

ASSEMBLAGGIO ACCESSORI

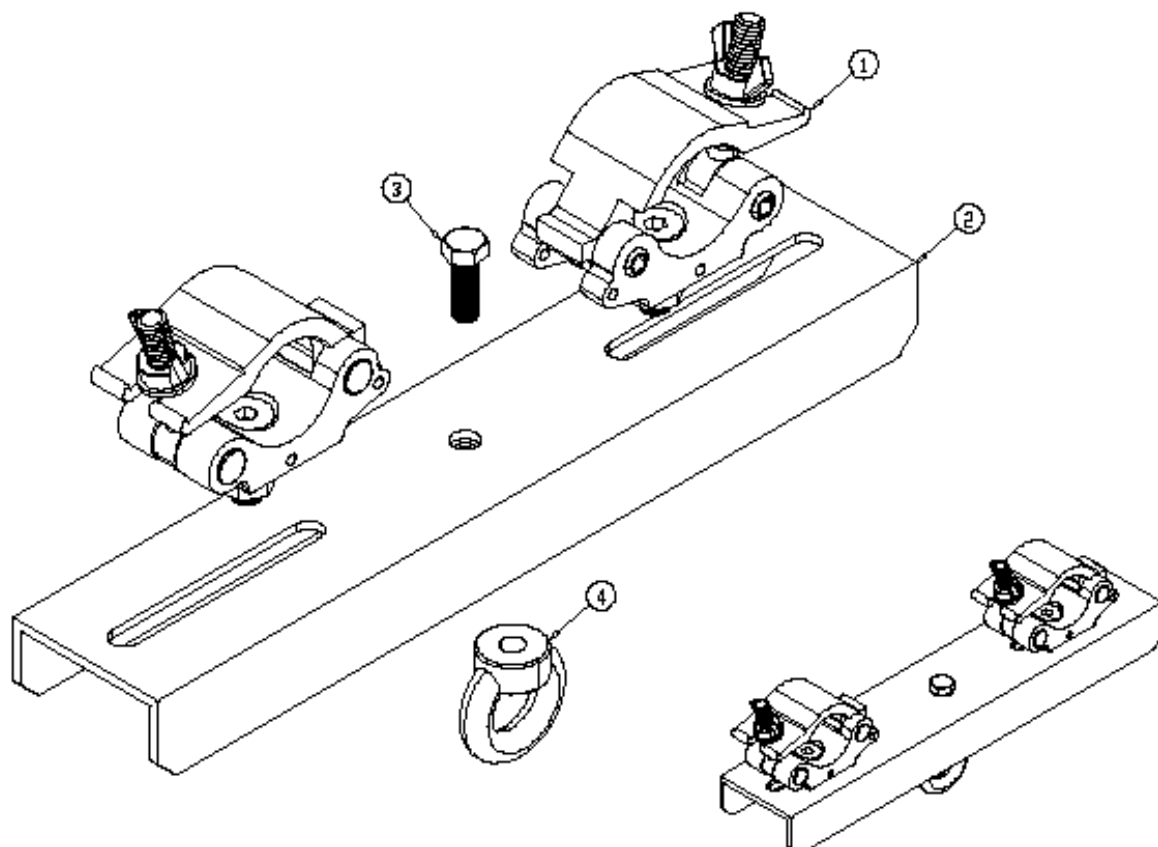

Numero	Codice	Descrizione	Quantità
1	AS01*	Gancio singolo in alluminio "Silver Finish"	2
2	ST/3	Componente base per supporto ST-03	1
3	B1225/EZ	Bullone testa esagonale dlm.12x25 mm zincato	1
4	G12	Golfare diam. 12 con foro (femmina)	1
			1

ST/03G -Supporto traliccio con golfare ad estensione regolabile min.30-max40 cm



PRESCRIZIONI DI UTILIZZO E ISTRUZIONI DI MONTAGGIO

Prescrizioni per l'utilizzo:

1. Non superare il carico di lavoro indicato nella scheda tecnica;
2. Utilizzare il gancio esclusivamente entro i parametri del tubo di progetto;
3. Ispezionare visivamente il gancio prima dell'uso. In caso di danneggiamento mettere fuori servizio;
4. Combinati con altri accessori, prestare attenzione a non superare la portata minima di qualsiasi componente;
5. Il gancio va utilizzato solo in un orientamento verticale (Fig.1). In caso contrario ridurre li carico;



Figura 1 Configurazione di lavoro.

6. Per un corretto utilizzo applicare al dispositivo di serraggio su tubo un momento torcente pari a 32 Nm.

Istruzioni di montaggio:

Per le istruzioni di montaggio e per ulteriori chiarimenti si rimanda al sito www.efestoproduction.com alla sezione **Ganci**.

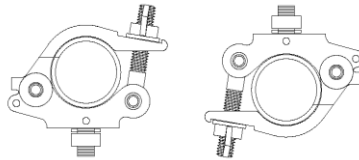

SCHEDA TECNICA

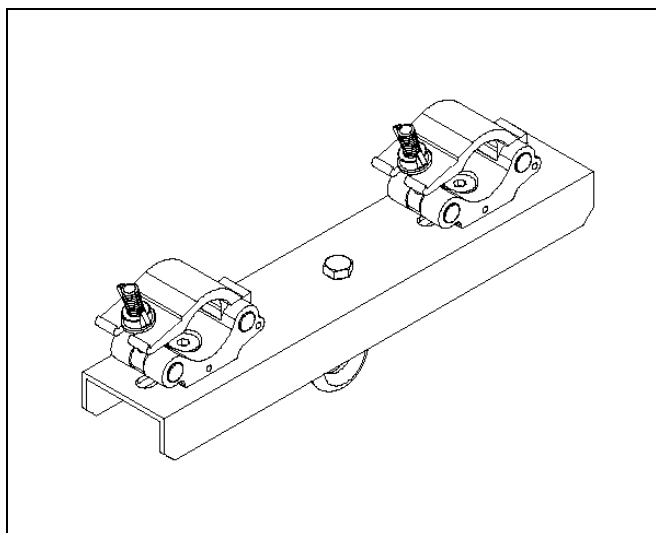
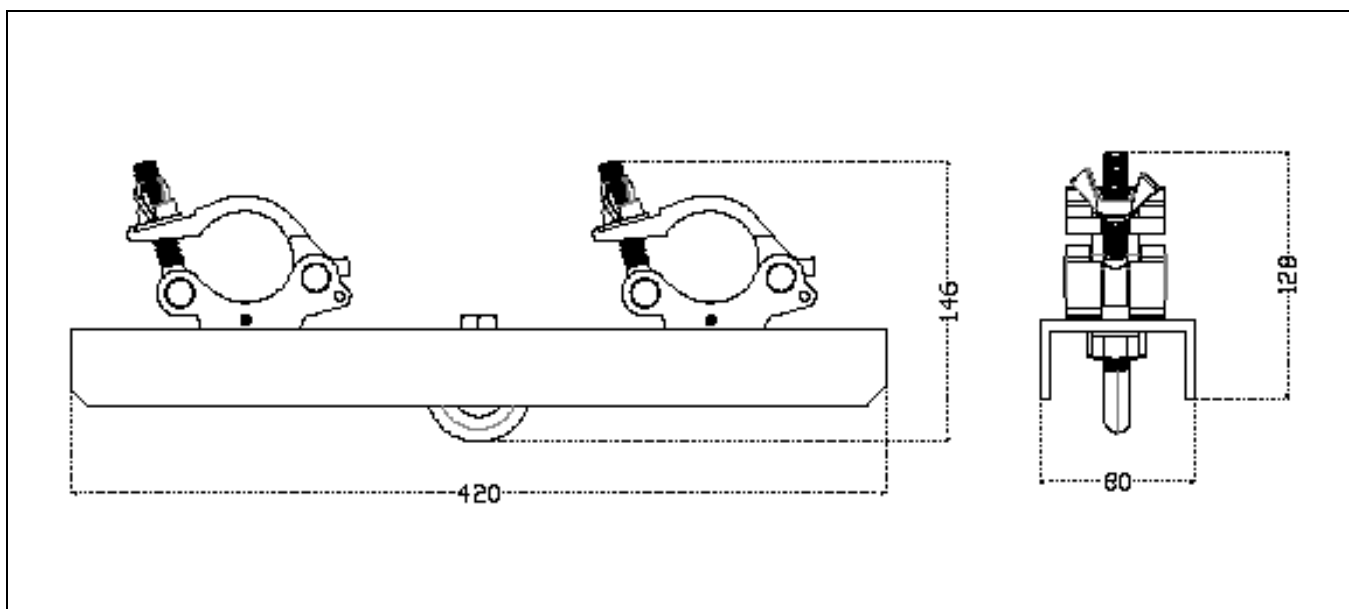

Specifica Tecnica

Dimensioni / Dimensions

146x420x80 mm

Materiale / Material

Lega EN AW-6060 T5 / Acciaio (C15E)

Finitura superficiale / Surface finish

Alluminio lucido / polished aluminum

Peso / Weight

2.700 kg

Volume trasporto / Transport volume

 0.0049 m³
Portata / Max. load

340 kg

Note / Notes

 Min. diametro tubo (*Min. tube diameter*) – 48 mm
 Max. diametro tubo (*Max. tube diameter*) – 51 mm

SERIE GANCI

Si riportano, di seguito, la serie di ganci prodotti, disponibili in verniciato argento o verniciato nero:

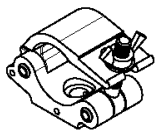

AS01



AS01S

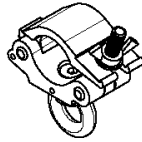

AG04



AG04S

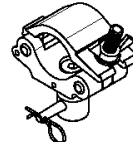

AM02

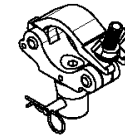

AM02S

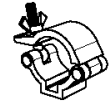

AS01/60



AS01/60G



AS01/60M02

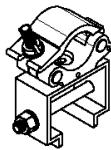

AS01/GCS

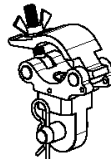

AS01/ST5050

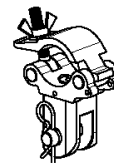

AS01/SU5050

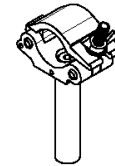

AS28

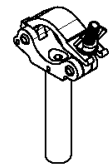

AS28S

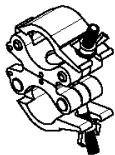

AD03

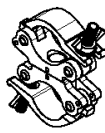

AD03S

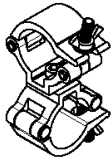

AD03/60

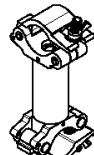

B/AS01



GC/01



GC/01A



GC/01AG



GC/01AM02



GC/01S



GC/01V

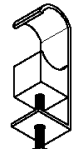

GC/02



GC/02A



GC/03A



GC/03AG



GC/03AM02

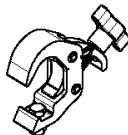

GC/04A



GC/04AG



GC/04AM02

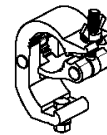

GC/05A



GC/05AG



GC/05AM02

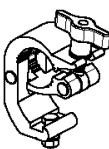

GC/06A

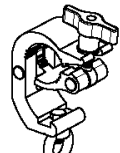

GC/06AG

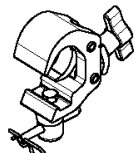

GC/06AM02

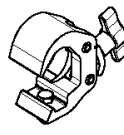

GC/07A

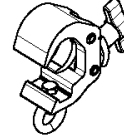

GC/07AG

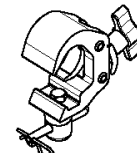

GC/07AM02

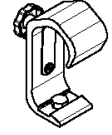

GC/08A

